

Inquiry    Order

Customer number: \_\_\_\_\_

Company stamp / address:

Contact person: \_\_\_\_\_

Telephone: \_\_\_\_\_

Quotation No.: \_\_\_\_\_

Commission: \_\_\_\_\_

Opening direction:    inwards folding    outwards folding

Number of systems: \_\_\_\_\_

Opening direction:    inwards folding    outwards folding   (Note: Use interior view!)

Number of panel: \_\_\_\_\_ to the left   \_\_\_\_\_ to the right   (Please draw a floor plan or a view sketch for better understanding)

Dimensions:   Width: \_\_\_\_\_ (Total unfolding)   Height: \_\_\_\_\_ (incl. possible floor recession)

Colour:    RAL 7016    RAL 9006    RAL 9007    RAL 9016    E6-EV1    Special colour \_\_\_\_\_  
 Pre anodizing

Colour of hinges:    E6-EV1 powder    RAL 9011 mat    RAL 9016    Special colour \_\_\_\_\_

Handle colour:    E6-EV1 powder    RAL 9011 mat    RAL 9016    Special colour \_\_\_\_\_

Handle height: H = \_\_\_\_\_  (Indicate handle height from lower panel edge)

Glazing:    Standard heat protection glass 2 x 4/20 SZR Ug 1.1  
 without glass: prepared for \_\_\_\_\_ mm  
 Special glass: \_\_\_\_\_ (Please indicate exact designation)

Floor connection:    with weathered bottom track

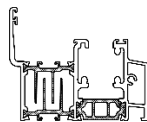

with flush bottom track (height incl. floor recession)



with recessed bottom track and lowerable bottom door seal (height including recess)

Locking of turn panel:  
(only possible with an add number of panels)

- Standard (shoot bolt lock operated from inside only)
- Shoot bolt lock with PZ (operated from both sides)
- Roller latch + 2 x dead lock + HEWI push handle
- Anti-draft lock with mushroom head and 4 point locking, latch and profile cylinder (operable on both sides)
- Pull handle for turn panel, outward folding system
- other: \_\_\_\_\_

Additional safety:    Twin-Lock  
 RC2-Safety package

Please enclose floor plan resp. view sketch and remarks (please use inside view)